

4.75 IN/120.65MM  
 TORPEDO DIA.

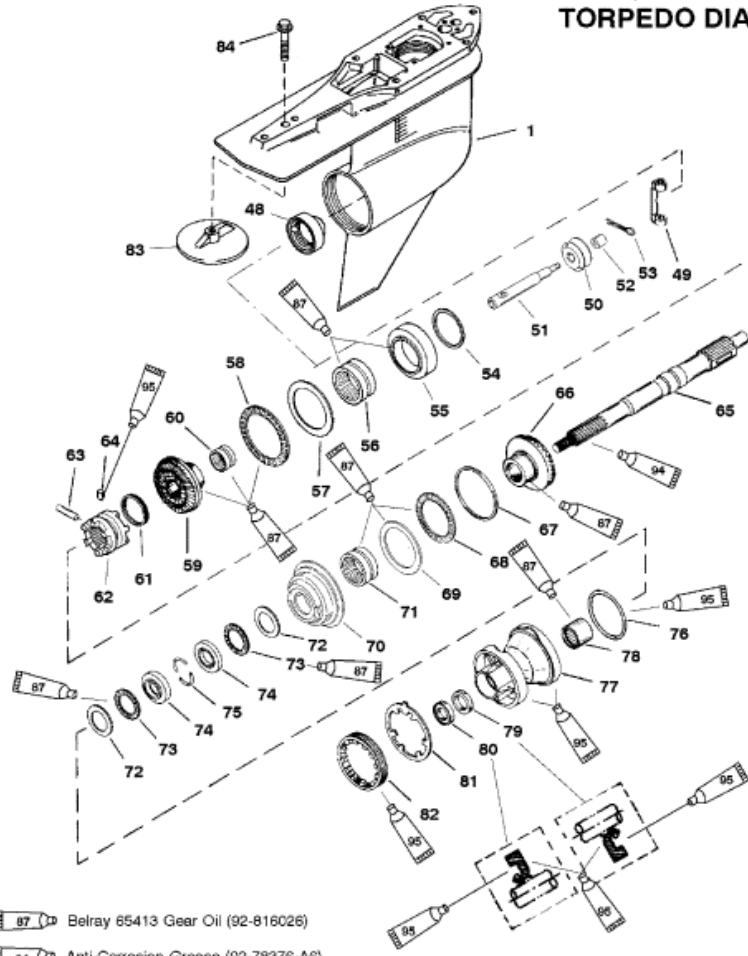

- 97 Belray 65413 Gear Oil (92-816026)
- 94 Anti-Corrosion Grease (92-78376-A6)
- 95 Chemtool Duralube Special (92-824501)

Parts List						
Ref	Class	Part	Description	Qty	Comment	Footnote
1	1623	859399T18	GEAR HOUSING	1		
48	22	859403	PLUG	1		
49		823903	SHIFT CRANK	1		
50		19755T 7	SHIFT SPOOL	1		
51		NSS	SPOOL	1		1
52		NSS	SLEEVE	1		1
53	18	46950 1	COTTER PIN	1		
54	15	44491A 1	SHIM SET	AR		3
55		828830A 2	BEARING ADAPTOR ASSEMBLY	1		
56	31	814653T	ROLLER BEARING	1		
57	12	815481	THRUST WASHER	1		
58	31	815480	THRUST BEARING	1		
59	43	828636T 2	REVERSE GEAR	1	(1.75:1 - 12/21)	
60	31	15844	ROLLER BEARING	1		
61	24	30893	SPRING	1		
62	52	859340T	SLIDING CLUTCH	1		
63	17	30632	CROSS PIN	1		
64	17	828356	DETENT PIN	1		
65	44	824111	PROPELLER SHAFT	1		
66	43	828635A 1	FORWARD GEAR	1	(1.75:1 - 12/21)	
67	23	17615 14	SPACER SHIM .206 IN.	AR		3
67	23	17615 15	SPACER SHIM .208 IN.	AR		3
67	23	17615 16	SPACER SHIM .210 IN.	AR		3
67	23	17615 17	SPACER SHIM .212 IN.	AR		3
67	23	17615 18	SPACER SHIM .214 IN.	AR		3
67	23	17615 19	SPACER SHIM .216 IN.	AR		3
67	23	17615 20	SPACER SHIM .218 IN.	AR		3
67	23	17615 21	SPACER SHIM .220 IN.	AR		3
67	23	17615 22	SPACER SHIM .222 IN.	AR		3
67	23	17615 23	SPACER SHIM .224 IN.	AR		3
67	23	17615 24	SPACER SHIM .226 IN.	AR		3
67	23	17615 25	SPACER SHIM .228 IN.	AR		3
67	23	17615 26	SPACER SHIM .230 IN.	AR		3
68	31	815480	ROLLER BEARING	1		
69	12	815481	THRUST RING	1		
70		828831A 3	BEARING ADAPTOR ASSEMBLY	1		
71	31	814653T	ROLLER BEARING	1		
72	12	18448	THRUST WASHER	2		
73	31	15842	THRUST BEARING	2		
74		818291 1	THRUST RACE	2		
75		814606	KEEPER	2		